

MDTE Series

Wire Wound Molded SMD Power Inductors

Size 8080



FEATURES

- So saturation
- High current, low DCR, high efficiency
- Very low acoustic noise and very low leakage flux noise
- High reliability
- 100% Lead (Pb)-Free and RoHS compliant
- Operating temperature -55~+125°C (Including self-temperature rise)
- Quantity: 450pcs

APPLICATION

- Note PC power system, incl. IMVP-6
- DC/DC converter

Dimensions: [mm]

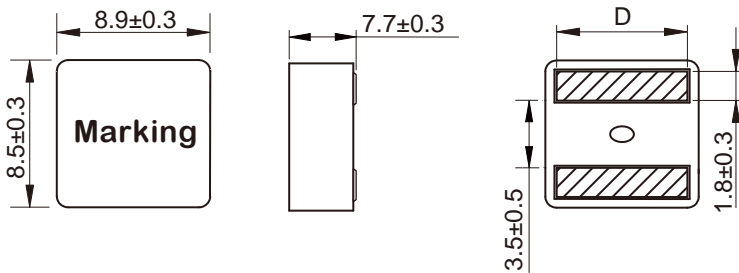

Land Pattern: [mm]

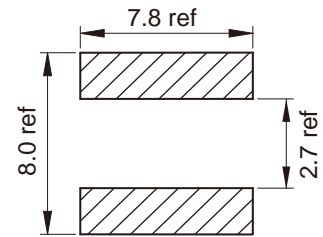

Electrical Properties:

Part Number	DCR (mΩ)	Inductance (μH)	DCR @ Sat (mΩ)	DCR @ 100°C (mΩ)	DCR @ 125°C (mΩ)	DCR @ 150°C (mΩ)	DCR @ 200°C (mΩ)
MDTE8080-1R8M	1.80	±20%	28.0	24.0	24.0	4.0	7.2±0.3
MDTE8080-2R2M	2.20	±20%	25.0	22.0	21.5	4.3	7.2±0.3
MDTE8080-3R3M	3.30	±20%	23.0	20.0	18.0	7.3	6.9±0.3
MDTE8080-4R7M	4.70	±20%	19.0	17.0	14.6	9.8	6.9±0.3
MDTE8080-6R8M	6.80	±20%	14.5	12.5	11.3	14.3	6.9±0.3
MDTE8080-100M	10.0	±20%	11.0	10.0	8.7	22.9	6.9±0.3

Saturation Current will cause L to drop approximately 30%

Temperature Rise Current: The actual value of DC current when the temperature rise is $\Delta T=40^{\circ}\text{C}$

Soldering Reflow:

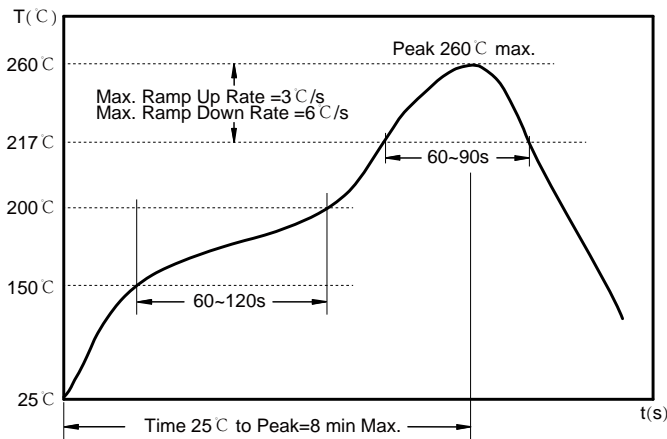

Preheat condition: 150 ~200°C / 60~120 sec.

Allowed time above 217°C: 60~90 sec.

Max temperature: 260°C.

Max time at max temperature: 10 sec.

Allowed Reflow time: 2x max.

Packaging Information:

Tape Dimension:

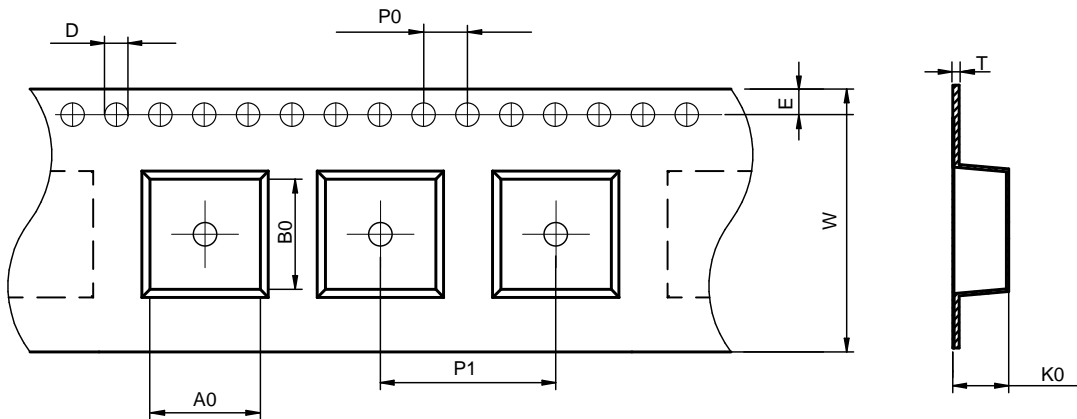

Series	A0 (mm)	B0 (mm)	D (mm)	P0 (mm)	P1 (mm)	W (mm)	K0 (mm)	E (mm)	T (mm)
MDTE8080	9.4±0.1	8.9±0.1	1.5±0.1	4.0±0.1	16.0±0.1	24.0±0.3	8.5±0.1	1.75±0.1	0.35±0.05

Peel force of top cover tape:

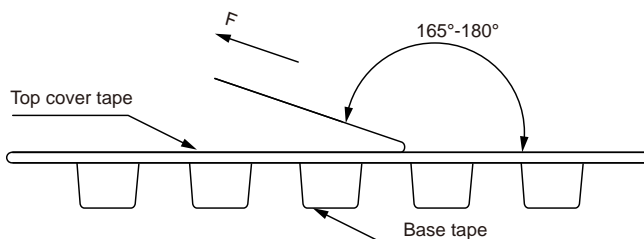

The peel force of top cover tape shall be between 0.1 to 1.3 N

Product Marking:

Marking	Printing (Inductance)
---------	-----------------------

The storage period is within 12 months after the comp

Reel Dimension: [mm]

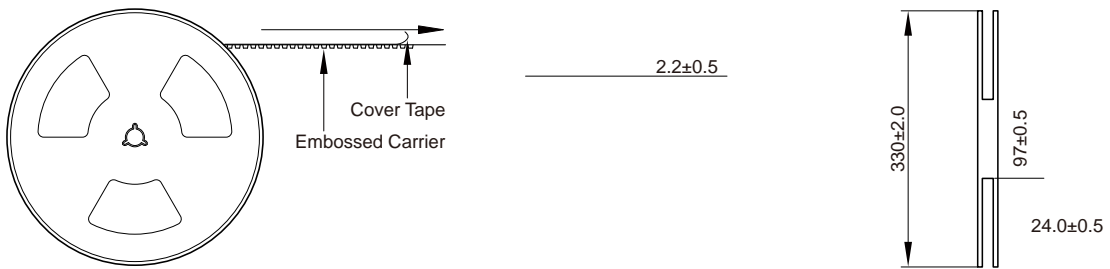

Packaging Quantity:

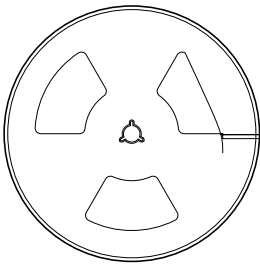

450 Pcs/Reel

2 Reel /Inner box(900 Pcs)

3 Inner box/Carton box(2.7K Pcs)

Cautions and Warnings:

Storage Conditions :

Operation Instructions: